

Product card -  
**Refrigeration  
sandwich panel**

**SPW-C CORE<sup>PIR</sup>**

**THE POWER OF ROOFS**



# Product card

## Refrigeration sandwich panel



Scan the code  
and learn more  
about the product!

Sandwich panels are high-performance products that meet the requirements of the modern construction market.

Suitable for the construction of exterior wall claddings and ceilings of cold storage, industrial and public utility buildings.

For the investor, it is a high quality product at a good price. For architects, it offers many possibilities in relation to the design intent. For construction managers, quick and easy installation. For construction supervision, friendly and transparent possibilities to verify the course of the entire process of construction execution from delivery until build acceptance.



# Technical information

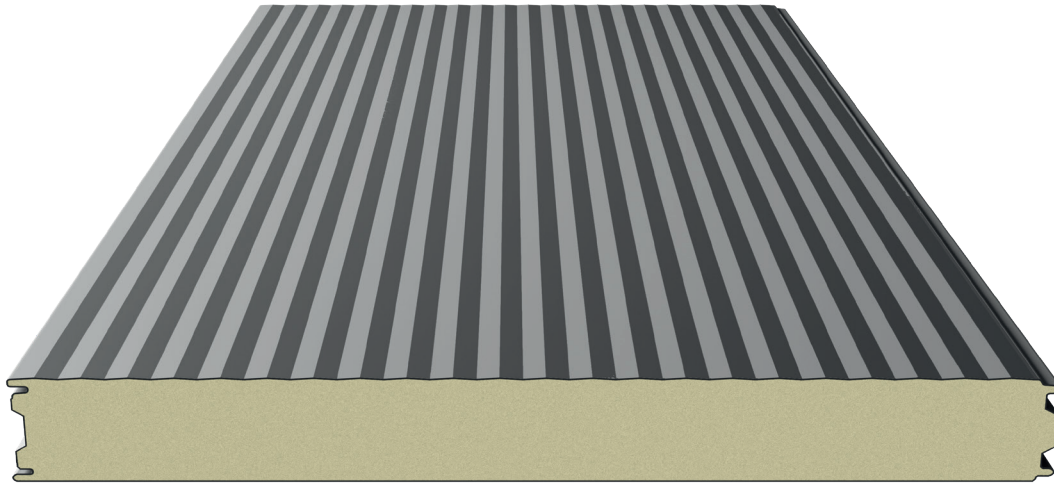

## Board cross-section

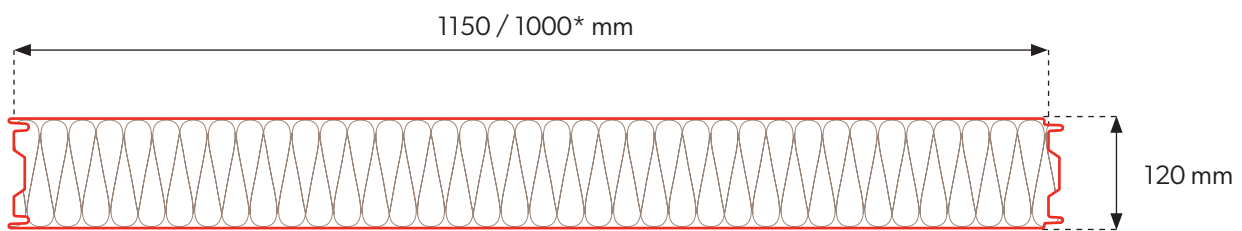

## Joining of panels

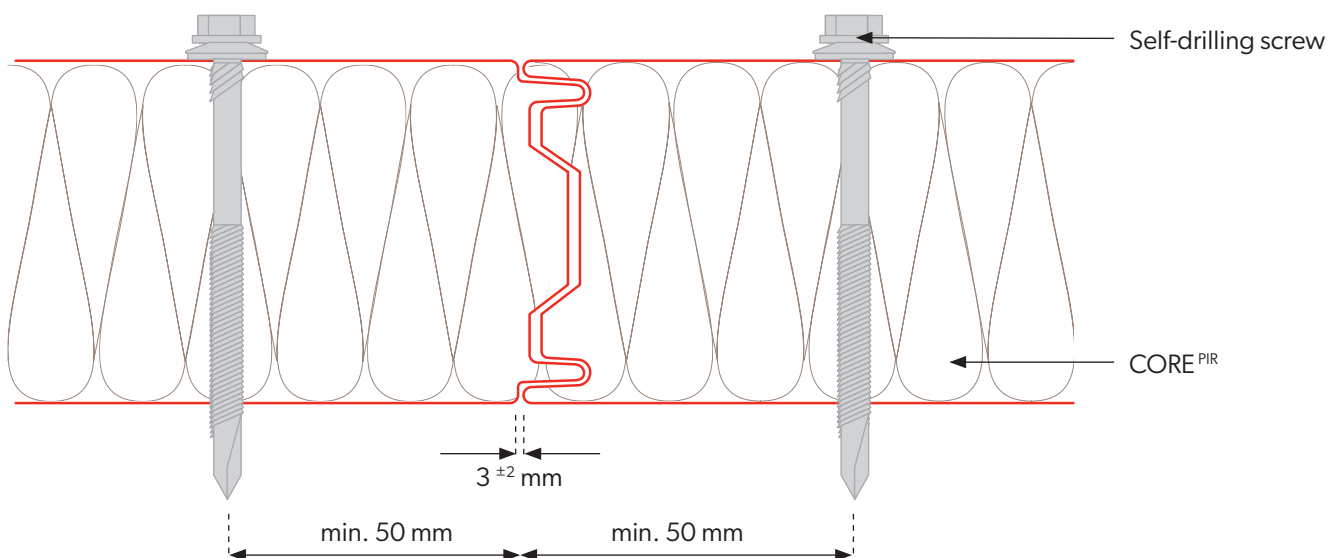

\* Module availability is determined individually with the sales department..

## Technical information

Core	<b>PIR</b>
Density [kg/m <sup>3</sup> ]	<b>40 ± 3</b>
PIR panel thickness [mm]	<b>120</b>
Weight [kg/m <sup>2</sup> ]	<b>12,8</b>
Effective width [mm]	<b>1150, 1000*</b>
Total width [mm]	<b>1171, 1021*</b>
Min. panel length [mb]	<b>2,5</b>
Max. panel length [mb]	<b>13,5</b>
Outer/inner sheet thickness [mm]	<b>0,4-0,7 / 0,4-0,7</b>
U-factor [W/m <sup>2</sup> K].	<b>0,18</b>
Reaction to fire	<b>B-s1,d0</b>
Wall resistance to external fire	<b>EI30</b>
Type of profiling ext. / int.	<b>[R], [M], [T], [F] / [M], [T], [F]</b>
Corrosion resistance ext. / ext.	<b>C1, C2, C3 (C4 ÷ C5) / A1 (A2 ÷ A5)</b>
Standard coatings	<b>Poliester Interior [INT], Poliester Standard [RAL], HERCULIT [HC], MULTILAYER 40 [MLT]</b>
Special coatings	<b>PVDF, PUR, PVC (P), PVC (F) - FoodSafe</b>
Accessories	<b>Fastening system, gaskets, flashings, lighting profiles</b>

## Packaging of sandwich panels

Panel thickness [mm]	Modular width [mm]	Quantity of panels in a package	Quantity of packages per vehicle	Maximum height of a parcel [mm]	Height of 2 parcels [mm]	Maximum loading length [m]	Quantity of panels per vehicle [m <sup>2</sup> ]
<b>120</b>	<b>1150</b>	<b>9</b>	<b>4</b>	<b>1180</b>	<b>2360</b>	<b>13,5</b>	<b>510,3</b>



Module availability is determined individually with the sales department.

# Technical information

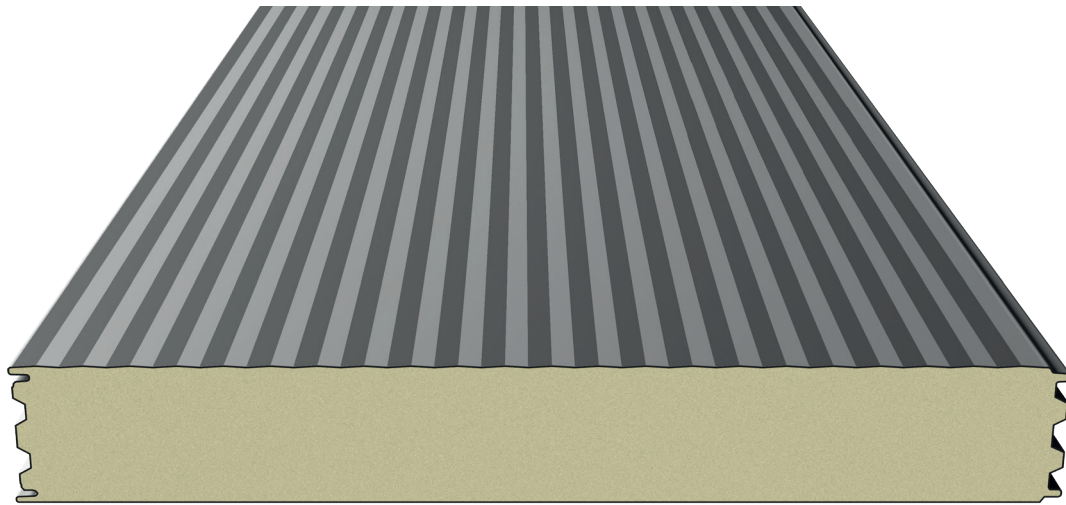

## Board cross-section

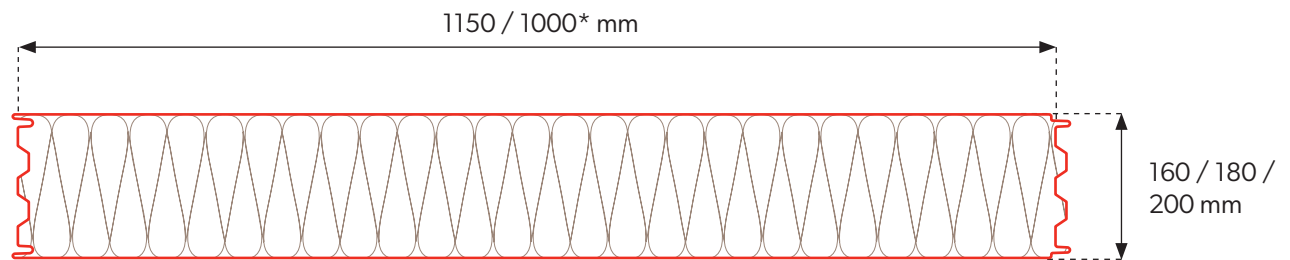

## Joining of panels

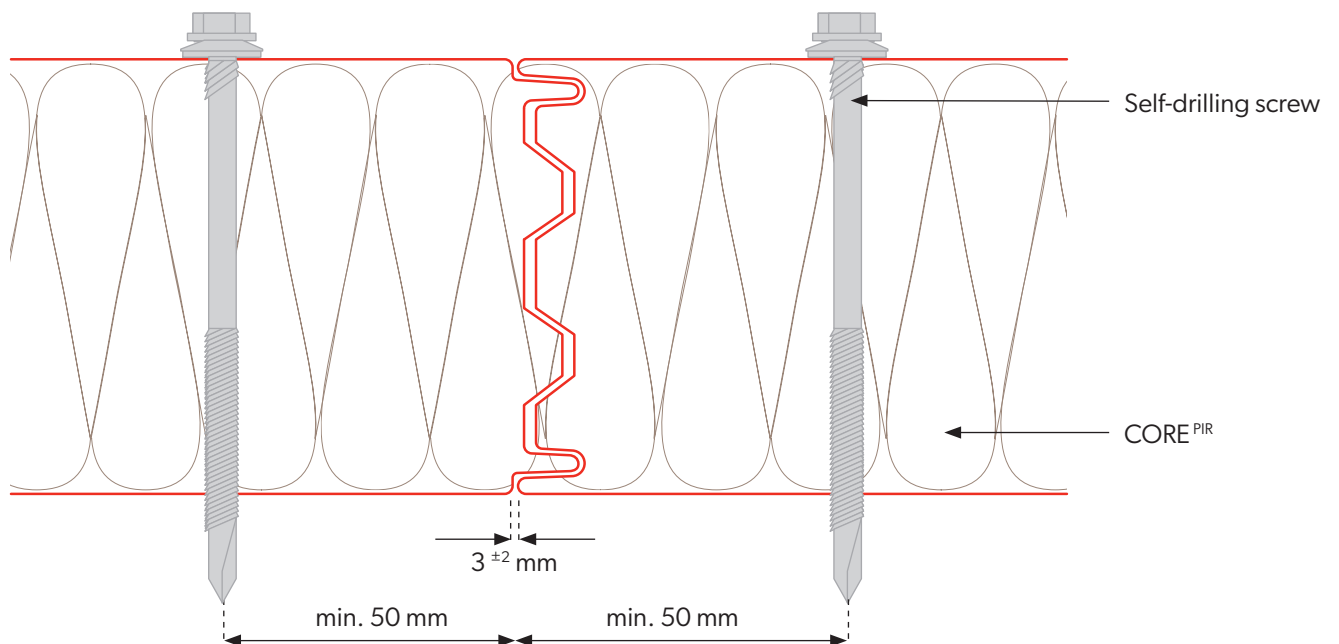

\* Module availability is determined individually with the sales department..

## Technical information

Core	PIR		
Density [kg/m <sup>3</sup> ]	40 ± 3		
PIR panel thickness [mm]	160	180	200
Weight [kg/m <sup>2</sup> ]	14,5	15,3	16,1
Effective width [mm]	1150, 1000*		
Total width [mm]	1171, 1021*		
Min. panel length [mb]	2,5		
Max. panel length [mb]	13,5		
Outer/inner sheet thickness [mm]	0,4-0,7 / 0,4-0,7		
U-factor [W/m <sup>2</sup> K].	0,14	0,12	0,11
Reaction to fire	B-s1,d0		
Wall resistance to external fire	EI30	EI30	EI30
Type of profiling ext. / int.	[R], [M], [T], [F] / [M], [T], [F]		
Corrosion resistance ext. / ext.	C1, C2, C3 (C4 ÷ C5) / A1 (A2 ÷ A5)		
Standard coatings	Poliester Interior [INT], Poliester Standard [RAL], HERCULIT [HC], MULTILAYER 40 [MLT]		
Special coatings	PVDF, PUR, PVC (P), PVC (F) - FoodSafe		
Accessories	Fastening system, gaskets, flashings, lighting profiles		

## Packaging of sandwich panels

Panel thickness [mm]	Modular width [mm]	Quantity of panels in a package	Quantity of packages per vehicle	Maximum height of a parcel [mm]	Height of 2 parcels [mm]	Maximum loading length [m]	Quantity of panels per vehicle [m <sup>2</sup> ]
160	1150	7	4	1220	2440	13,5	434,7
180	1150	6	4	1180	2360	13,5	372,6
200	1150	5	4	1100	2200	13,5	310,5



Module availability is determined individually with the sales department.

## External profiling

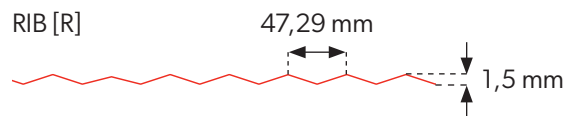
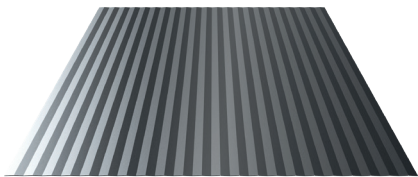
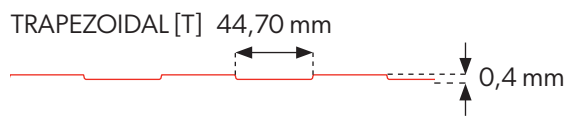
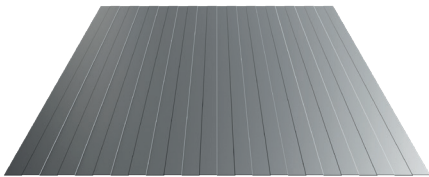
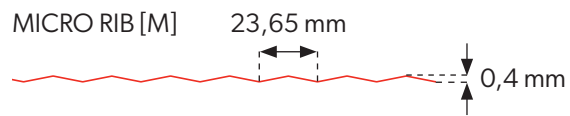
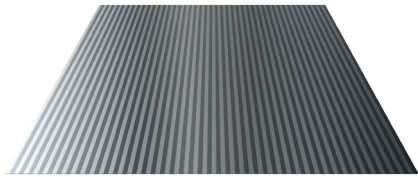

FLAT [F]



## Internal profiling

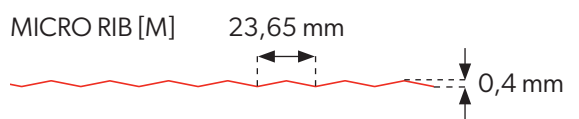
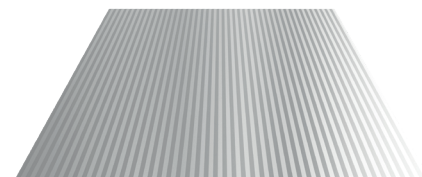
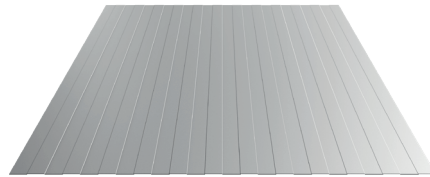

FLAT [F]



Internal and external profiling are available in any configuration.

## Coatings and colors

**POLIESTER Interior [INT]** - Available colors for interior cladding

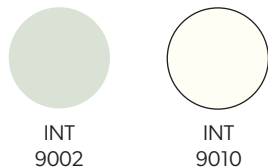

**POLIESTER Standard [RAL]** - Available colors for exterior cladding

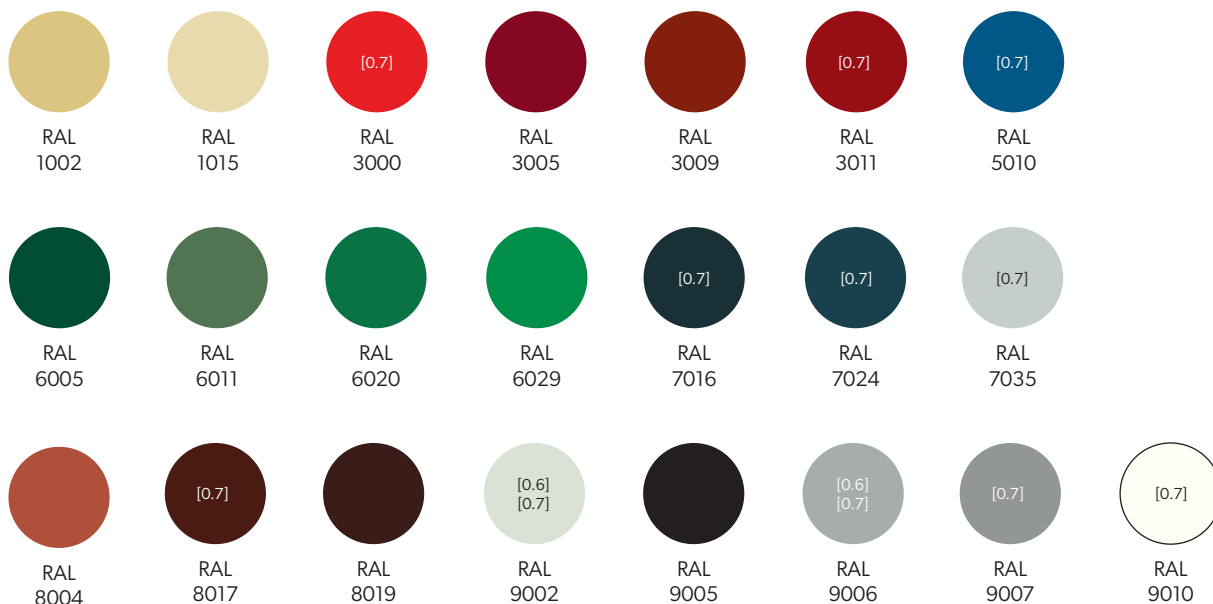

**HERCULIT [HC]**

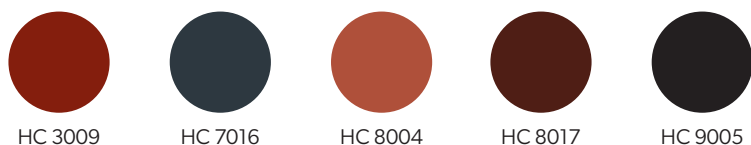

**MULTILAYER 40 [MLT]** - Available colors for exterior cladding



Printing technology does not allow faithful rendering of colors. Therefore the colors shown are indicative and may differ from actual colors.



In addition, on individual order, non-standard colors and coatings are available, outside the palette shown (PVDF, PUR, PVC (P), PVC (F) - FoodSafe).



## Coating parameters

Code	Coating thickness	Corrosion resistance	UV resistance
POLIESTER Interior [INT]	15 µm	RA2	Not applicable
POLIESTER Standard [RAL]	25 µm	RC3	RUV2
HERCULIT [HC]	35 µm	RC4	RUV4
MULTILAYER 40 [MLT]	40 µm	RC3	RUV3

## Notes

A large grid area for taking notes, consisting of approximately 30 columns and 30 rows of small squares.



Modular roofing tiles  
**MODULAR SERIES**



Compact roofing tiles  
**COMPACT SERIES**



Steel roofing tiles  
**CLASSIC SERIES**



Retro roof tiles  
**RETRO SERIES**



Roof panels  
**PANEL SERIES**



INTEGRATED  
**PV PANELS**



Steel roof gutter system  
**INGURI**



**TRAPEZOIDAL**  
SHEETS



**FLAT METAL**  
SHEETS



**FLASHINGS**



**ACCESORIES**



Roof Sandwich  
PANELS



Wall Sandwich  
PANELS



Facade cladding  
**SKRIN, LINEA, SINUS**



Wall cassette &  
**PROSYSTEM**



Uncoiling and slitting  
**SERVICES**



Flat sheets and cutting  
**SERVICES**



**PERFORATION**  
of sheets

