



Product card - **Wall sandwich panel with visible fastening**

SPW-S CORE^{PIR}

THE POWER OF ROOFS



Product card

Wall sandwich panel with visible fastening

SPW-S CORE^{PIR}



Scan the code
and learn more
about the product!

Sandwich panels are high-performance products that meet the requirements of the modern construction market.

Suitable for the construction of exterior and interior wall claddings and ceilings of industrial or public utility facilities.

For the investor, it is a high quality product at a good price. For architects, it offers many possibilities in relation to the design intent. For construction managers, quick and easy installation. For construction supervision, friendly and transparent possibilities to verify the course of the entire process of construction execution from delivery until build acceptance.

Technical information

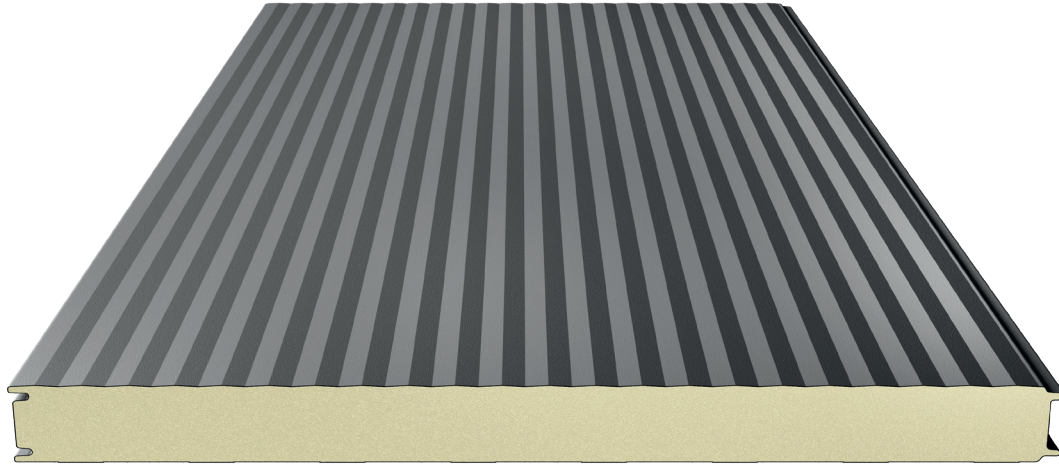

Board cross-section

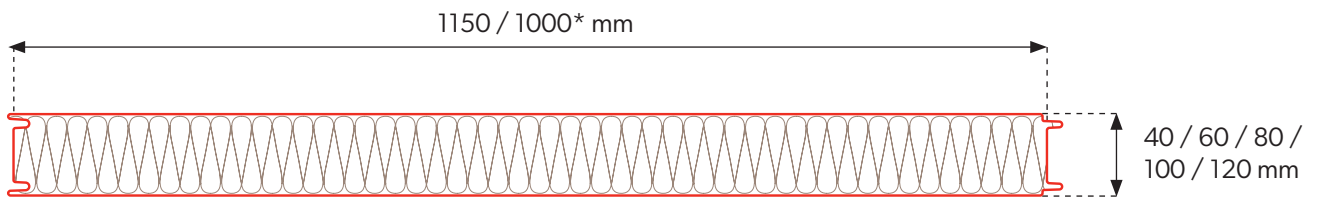

Joining of panels

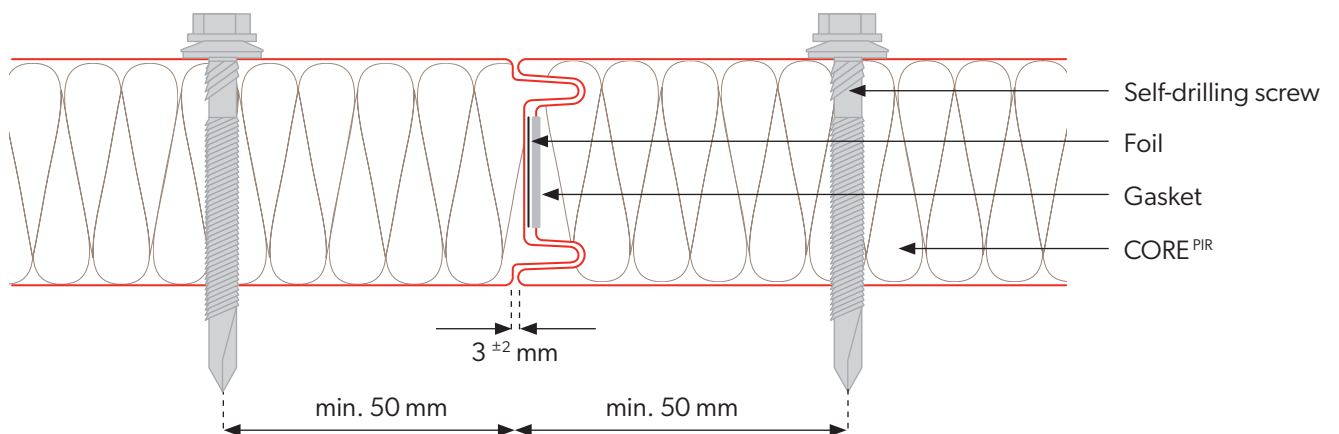

Module availability is determined individually with the sales department.

Technical information

Core	PIR				
Density [kg/m ³]	40 ± 3				
PIR panel thickness [mm]	40	60	80	100	120
Weight [kg/m ²]	9,4	10,3	11,1	11,9	12,8
Effective width [mm]	1150, 1000*				
Total width [mm]	1171, 1021*				
Min. panel length [mb]	2,5				
Max. panel length [mb]	13,5				
Outer/inner sheet thickness [mm]	0,4-0,7 / 0,4-0,7				
U-factor [W/m ² K].	0,55	0,37	0,28	0,22	0,18
Reaction to fire	B-s1,d0				
Wall resistance to external fire	EI15	EI15	EI15	EI45	EI45
Type of profiling ext. / int.	[R], [M], [T], [F] / [M], [T], [F]				
Corrosion resistance ext. / ext.	C1, C2, C3 (C4 ÷ C5) / A1 (A2 ÷ A5)				
Standard coatings	Poliester Interior [INT], Poliester Standard [RAL], HERCULIT [HC], MULTILAYER 40 [MLT]				
Special coatings	PVDF, PUR, PVC (P), PVC (F) - FoodSafe				
Accessories	Fastening system, gaskets, flashings, lighting profiles				

Packaging of sandwich panels

Panel thickness [mm]	Modular width [mm]	Quantity of panels in a package	Quantity of packages per vehicle	Package height [mm]	Package weight [kg]	Maximum loading length [m]	Quantity of panels per vehicle [m ²]
40	1150	19	6	2580	2565	13,5	1769,85
60	1150	13	6	2640	1924	13,5	1210,95
80	1150	15	4	2580	2400	13,5	931,5
100	1150	12	4	2580	2064	13,5	745,2
120	1150	6	6	2430	1110	13,5	558,9



Module availability is determined individually with the sales department.

External profiling

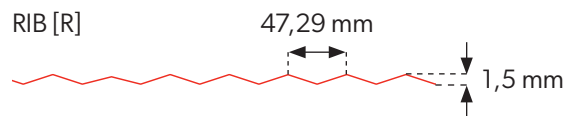
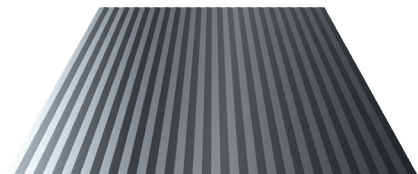
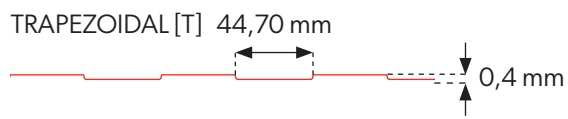
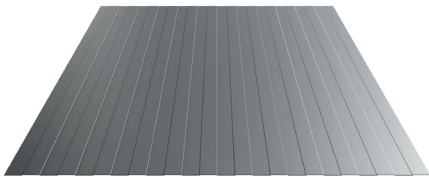
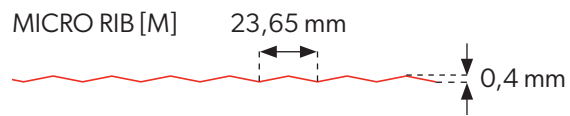
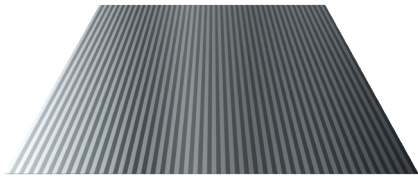

FLAT [F]

Internal profiling

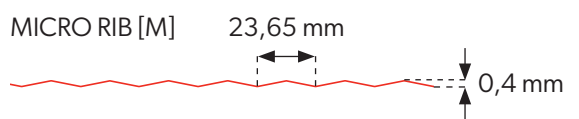
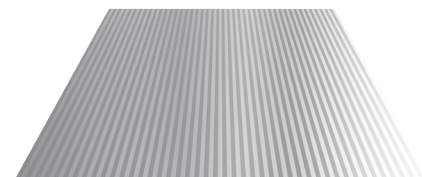
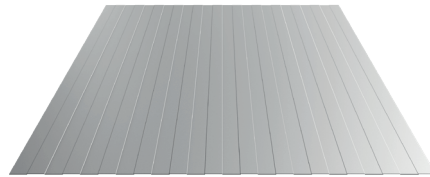

FLAT [F]



Internal and external profiling are available in any configuration.

Coatings and colors

POLIESTER Interior [INT] - Available colors for interior cladding

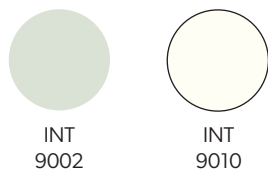

POLIESTER Standard [RAL] - Available colors for exterior cladding

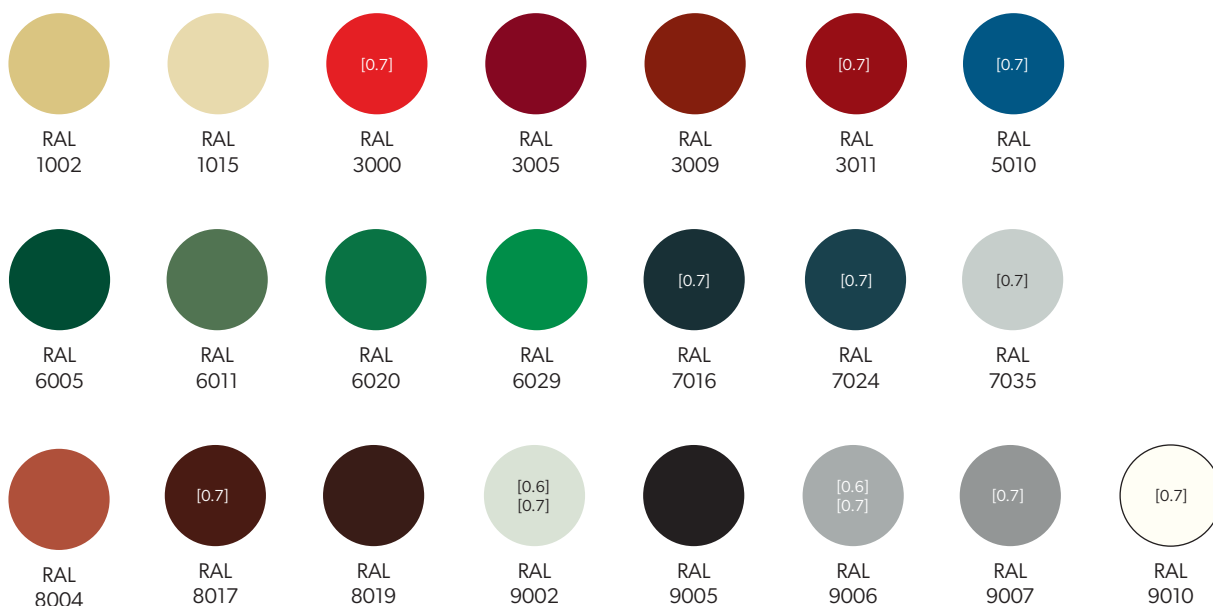

HERCULIT [HC]

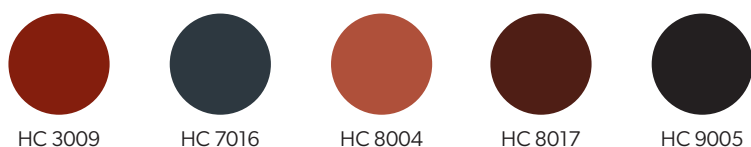

MULTILAYER 40 [MLT] - Available colors for exterior cladding



Printing technology does not allow faithful rendering of colors. Therefore the colors shown are indicative and may differ from actual colors.



In addition, on individual order, non-standard colors and coatings are available, outside the palette shown (PVDF, PUR, PVC (P), PVC (F) - FoodSafe).

Coating parameters

Code	Coating thickness	Corrosion resistance	UV resistance
POLIESTER Interior [INT]	15 μm	RA2	Not applicable
POLIESTER Standard [RAL]	25 μm	RC3	RUV2
HERCULIT [HC]	35 μm	RC4	RUV4
MULTILAYER 40 [MLT]	40 μm	RC3	RUV3

Notes



Modular roofing tiles
MODULAR SERIES



Compact roofing tiles
COMPACT SERIES



Steel roofing tiles
CLASSIC SERIES



Retro roof tiles
RETRO SERIES



Roof panels
PANEL SERIES



INTEGRATED
PV PANELS



Steel roof gutter system
INGURI



TRAPEZOIDAL
SHEETS



FLAT METAL
SHEETS



FLASHINGS



ACCESORIES



Roof Sandwich
PANELS



Wall Sandwich
PANELS



Facade cladding
SKRIN, LINEA, SINUS



Wall cassette &
PROSYSTEM



Uncoiling and slitting
SERVICES



Flat sheets and cutting
SERVICES



PERFORATION
of sheets

